

File Path C:\Users\Susan.Broom\Kier\RoadZone - Design\237444 - SLB - Marham Park - Access restrictions\3 - Drawings (E)\AutoCAD\237444-FAS-0100.dwg

Plot date 10/11/2021

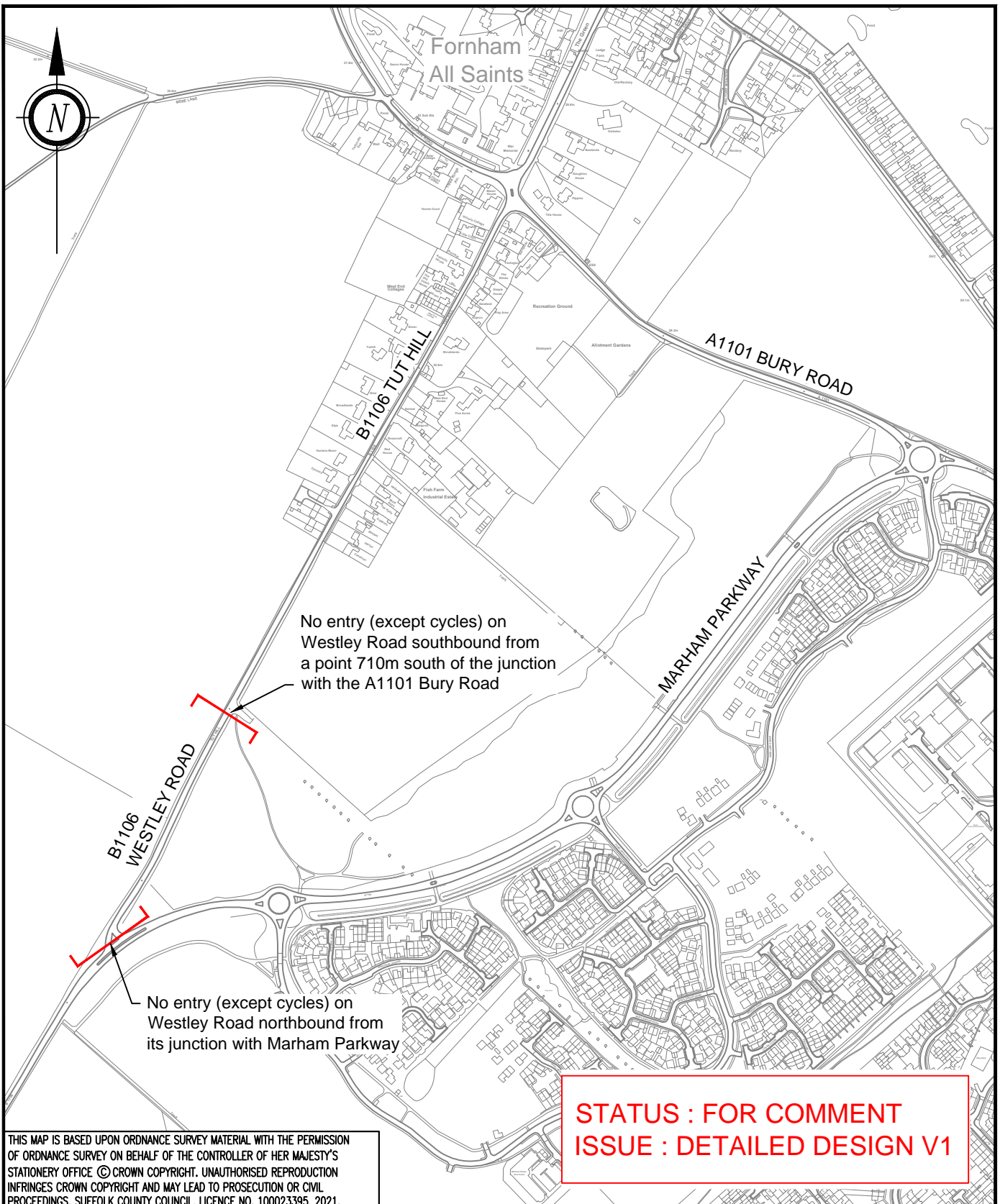

THIS MAP IS BASED UPON ORDNANCE SURVEY MATERIAL WITH THE PERMISSION OF ORDNANCE SURVEY ON BEHALF OF THE CONTROLLER OF HER MAJESTY'S STATIONERY OFFICE © CROWN COPYRIGHT. UNAUTHORISED REPRODUCTION INFRINGES CROWN COPYRIGHT AND MAY LEAD TO PROSECUTION OR CIVIL PROCEEDINGS. SUFFOLK COUNTY COUNCIL, LICENCE NO. 100023395, 2021.



Phoenix House, 3 Goddard Road, Ipswich, Suffolk IP1 5NP.
Highways enquiries: 0345 606 6171 www.suffolk.gov.uk/highways

REVISION(S)						
DESCRIPTION				REV.	DATE	INTL.
ORIGINATOR	CHECKER	DESIGNER	REVIEWER			
SLB	JWW	SLB	GER			
SCALE(S)	ORIGINAL SIZE A4	DATE				
N.T.S.		01 NOV 2021				
DRAWING NUMBER			REVISION			
237444/FAS/0100						

PROJECT TITLE
WESTLEY ROAD, FORNHAM ALL SAINTS
PROPOSED 'NO ENTRY' RESTRICTIONS

DRAWING TITLE
CONSULTATION PLAN